

REV.	LOCAS.	DESCRIPTION	DATE	DRAWN
01		INITIAL RELEASE.	2010.11.8	WU

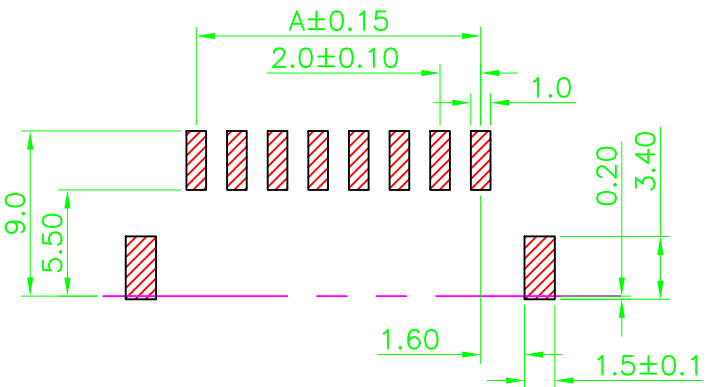
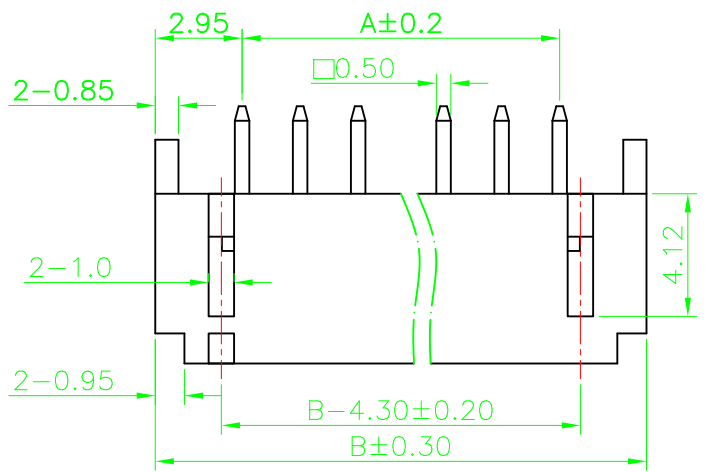

Specifications
Voltage Rating: 100V(AC,DC)
Current Rating: 2A(AC,DC)
Insulation Resistance: 1000MΩ Min.
Dielectric Withstanding: 800VAC/minute
Contact Resistance: 20mΩ Max.
Operating Temperature: -25°C to +85°C

Material:
Contact Material: Brass
Contact Plating: Tin Plated
Base Material: Nylon 6T, UL 94V-0

P.C.B LAYOUT

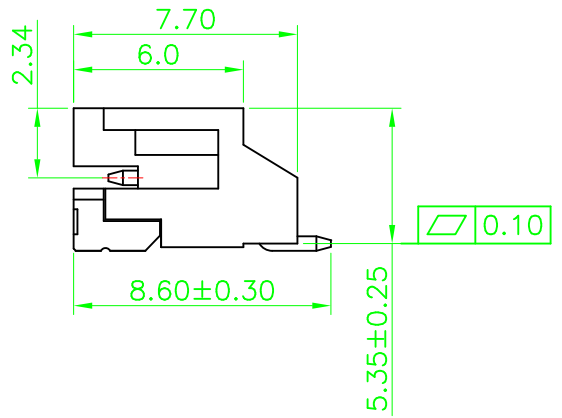
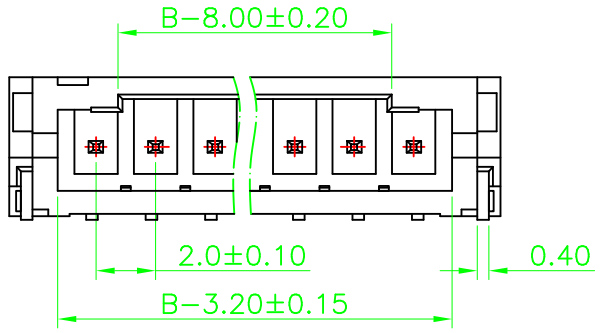

Ordering Information

GRC71 - XX XX WS01 X

No. of Pins per Row
02-16

Contact Plating
01=Tin
02=Gold Flash

COLOR
B=GRAY
C=BLUE
D=WHITE
R=RED

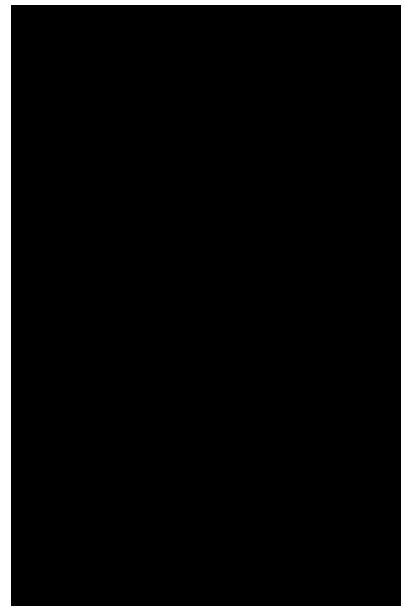

GERON ELECTRONIC CO., LTD

GENERAL TOLERANCE	
X.* ± 1.5*	X. ± 0.30
.X* ± 1.0*	.X ± 0.20
.XX* ± 0.5*	.XX ± 0.15
.XXX* ± 0.3*	.XXX ± 0.10

DESIGN: WU
CHECKED: ZHOU
AUDITED: ZHOU

DATE: 2010.11.8
DATE: 2010.11.8
DATE: 2010.11.8

DRAWING GRC71-WS01
PART NO.
GRC71-XX-XX-WS01-X

TITLE
PITCH 2.00 WAFER SMT TYPE

REV.	UNIT.	SCALE.	PAGE.	
01	mm	4:1	1/1	